

Victaulic Vortex™ Fire Suppression System

DATA SHEET

FORM NO. 10-WMV-004.1

ISSUE NO. A

DATE. 17/04/2023

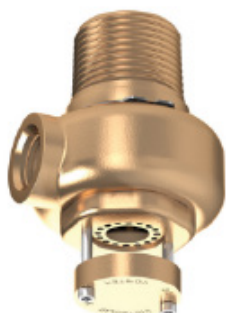

Standard Emitter



Escutcheon Emitter



PVDF Emitter

SERIES 953 and Series 954 Hybrid Emitters
Patent # 7,721,811 - High velocity low pressure emitters. Foreign patents also applied for and granted.



Product Overview

The homogeneous suspension of inert gas mixed with ultra-fine droplets of water mist protects enclosures with two extinguishment mechanisms that are occurring simultaneously: flame temperature cooling and lowering of the ambient oxygen level.

Description

The Emitter is a Victaulic-patented device designed to distribute the hybrid water and nitrogen mixture to the hazard at a high velocity low pressure delivery. The water and nitrogen are mixed at the emitter and distributed as a homogenous suspension with great momentum. Using proprietary supersonic atomization technology, the emitter atomizes the water to <math><10\mu\text{m}</math> forming a dense homogeneous suspension of nitrogen and water when discharged as total flooding fire suppression system.

Emitter Kit Includes:

- 19 mm / 3/4" NPT strainer, 100 mesh
- 19mm / 3/4" NPT 0.26 GPM/0.98 LPM Flow cartridge (Class A/E)
- 19 mm / 3/4" NPT 1.06 GPM/4.0 LPM flow cartridge (Class B)

- 19 mm / 3/4" NPT fittings
- 19 mm / 3/4" NPT to 9.5 mm / 3/8" copper tube compression fittings
- 6.4 mm / 1/4" NPT x 9.5 mm / 3/8" 90° copper tube compression fitting

NOTE: 0.5 mm / 3/8" tubing is not included

APPROVALS

Performance Certification	FM Approved (Class B)
Hydraulic Software	NFPA770 Hybrid Water Mist Compliant UL Verified

FEATURES & BENEFITS

- Large flow orifices
- Not prone to blockage
- Pendant or horizontal orientation
- Made from corrosion resistant materials

APPLICATIONS

- Total flood applications
- Local Applications
- Transformers
- Generator Rooms
- Turbines
- Hydraulic rooms
- Pickling Lines
- Extinguishment of 'Class B' hydrocarbons
- Data Centres/File Server Rooms/ MCC Rooms

MATERIAL SPECIFICATIONS

Body (Foil, Water Jacket):	UNS C36000 or UNS S316000 Stainless or Polyvinylidene Fluoride (PVDF) Plastic with Teflon* * Teflon is a registered trademark of Dupont Co.
Finish:	Plain Brass or Stainless Steel. Contact Victaulic for coatings other than standard options noted.
Orifice Size:	15mm / ½" (Class B), 15.87mm/5/8" (Class A/E)
Nitrogen Flow:	½" Class B Emitter 145 SCFM 44.2m3/m3 5/8" Class A/E Emitter 230 SCFM/70m3/m
Water Flow:	1.06 GPM /4.01 LPM (Class B), 0.26 GPM/0.98 LPM Flow Cartridge (Class A/E)
Orientation:	Pendent for machinery spaces, pendent or sidewall for turbine enclosures - avoid direct impinging on casing
Nitrogen Inlet:	19mm / ¾" Male NPT
Water Inlet:	6.4mm / ¼" Female NPT
Temperature Rating:	None, open

Installation

Reference should always be made to the applicable I-VORTEX-1500_Rev_F Victaulic Design and Installation Manual for the product you are installing. Manuals are included with each shipment of Victaulic products for complete installation and assembly data.

Dimensions

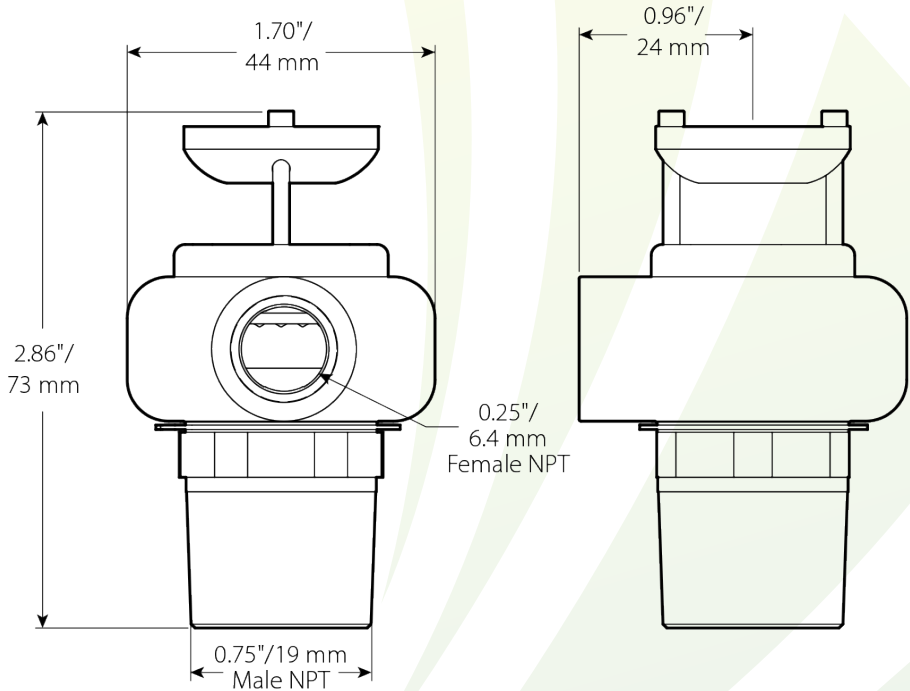

Note

This product shall be manufactured by Victaulic or to Victaulic specifications. All products to be installed in accordance with current Victaulic installation/assembly instructions. Victaulic reserves the right to change product specifications, designs and standard equipment without notice and without incurring obligations.