

Propane Systems Installation Guide

Single Tank System

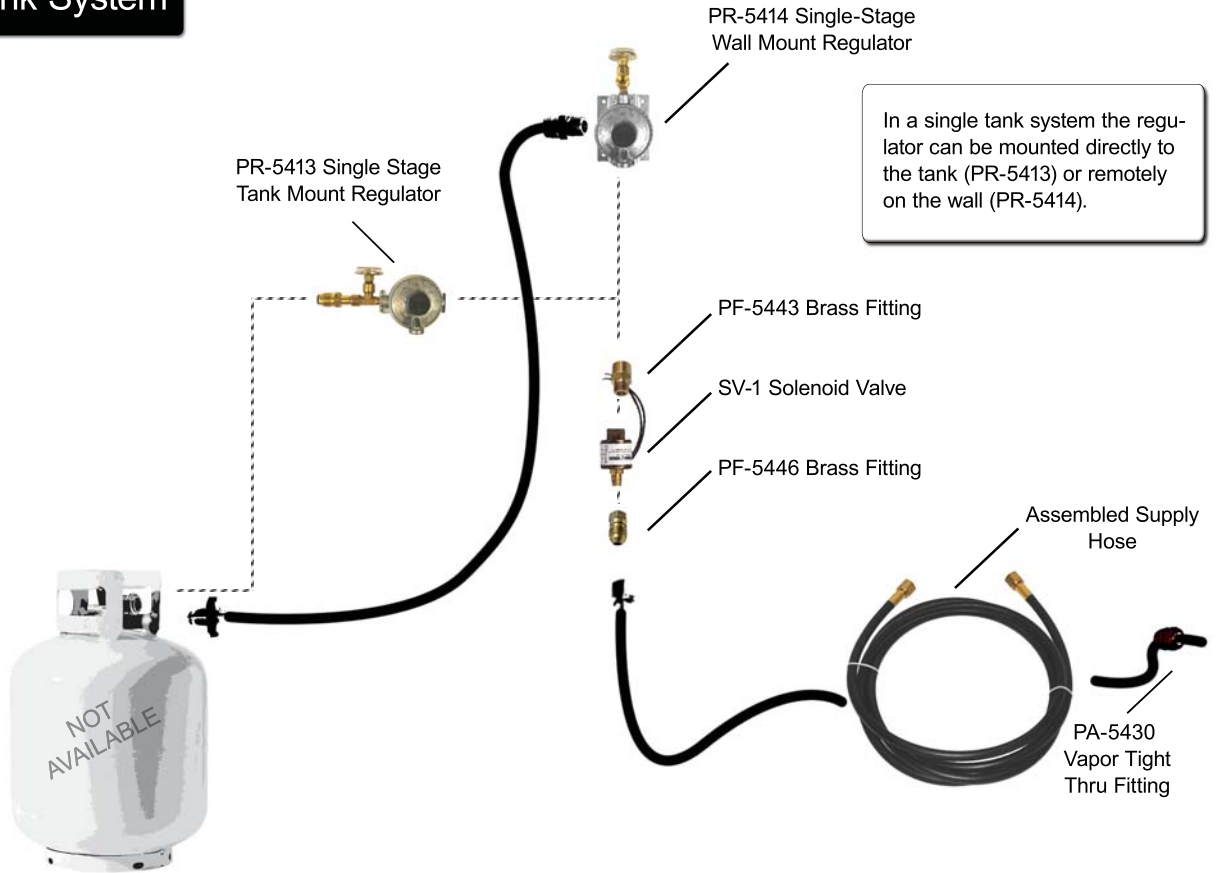

* Illustration not to scale.

ABYC Marine LPG System Leak Test

Test for system leakage each time the cylinder supply valve is opened for appliance use. With the appliance valves off, open the solenoid shut-off valve, if installed, and open the cylinder supply valve. Close the cylinder supply valve. Observe the pressure gauge reading. The pressure indicated should remain constant for not less than three minutes. If any leakage is indicated by a drop in pressure, check the entire system with a leak detection fluid or detergent solution to locate the leak. Test solutions must be both non-corrosive and non-toxic, and repairs must be made before operating the system.

WARNING: Never use flame to check for leaks.

When in doubt, consult a certified LPG system installer or specialist to ensure proper repair and installation.

For additional installation instructions, please refer to Fireboy-Xintex's "Marine Propane Systems Recommended Installation" instruction guide available at www.fireboy-xintex.com.